

**The Barons
St Margarets Village
TW1 2AN**

£600,000

ChaseBuchanan



The Barons TW1

Approximate Gross Internal Floor Area = 58.0 sq m / 624 sq ft

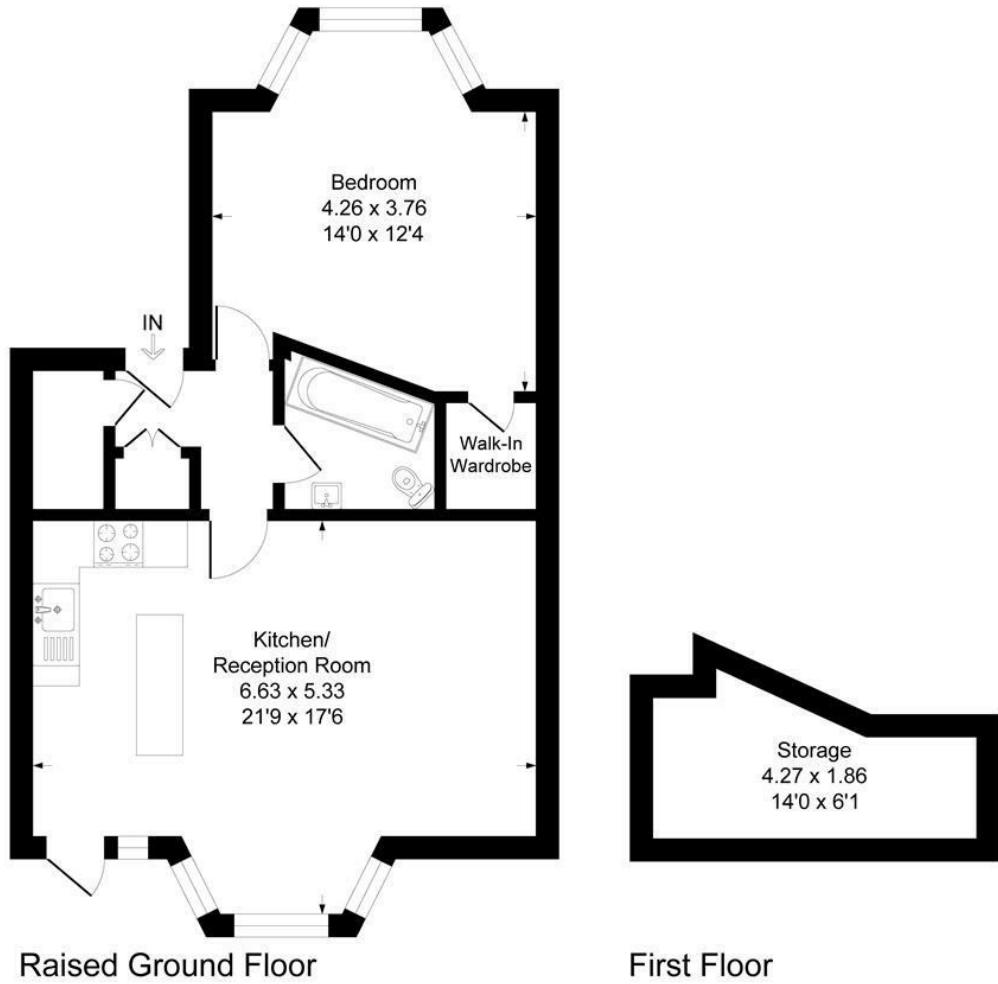
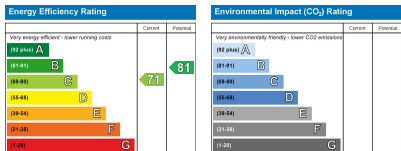

Illustration for identification purposes only, measurements are approximate, not to scale.



Care has been taken in the preparation of these particulars, however, their accuracy is not guaranteed and they do not form part of any contract. Measurements stated must be considered maximum.

- Viewings accompanied by Chase Buchanan
- Raised ground floor
- Balcony
- Off street parking
- Victorian conversion apartment
- Extremely high ceilings
- One bedroom
- Share of freehold

Located in the iconic 'Barons', this larger than average one bedroom raised ground floor Victorian conversion is ideally located for St Margarets Villages local amenities and mainline station to London Waterloo.

The apartment boasts an extremely large reception with extremely high ceilings and feature fireplace, an open kitchen area featuring an island and access to a balcony. The large bedroom benefits from a large bay window and walk-in wardrobe with the added benefit of a useable raised mezzanine area. The family bathroom completes the generously proportioned accommodation.

The residence offers full vacant possession, a share of the freehold, a long lease and low service charges. An appointment to view is highly recommended via the vendors agents Chase Buchanan at the earliest opportunity.

For more information or to book a viewing, please contact:

020 8744 2434

ChaseBuchanan

124 St Margarets Road, St Margarets, TW1 2AA